



Équipements et consultant pour l'industrie du plastique
Equipment and consulting for the plastic Industry

BARWAY



EXTENSION COUPLINGS FOR EXTRA HOLDING POWER

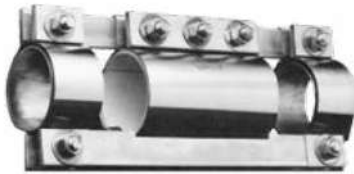

Extension kits are available for 3 & 4 bolt couplings from 2" OD up to 12" OD. Consult Lorenz for details.



MISSION

TRANQUILITÉ
D'ESPRIT

de nos clients.



HOW TO SELECT THE PROPER STRIPWOUND METAL HOSE?



Unpacked



Packed



Packing

BOYAU ASPIRATION (FDA, USDA ET 3A)

+/- .25 mur

Avec ou sans fils statique

PVC Claire -23°C à +65°C

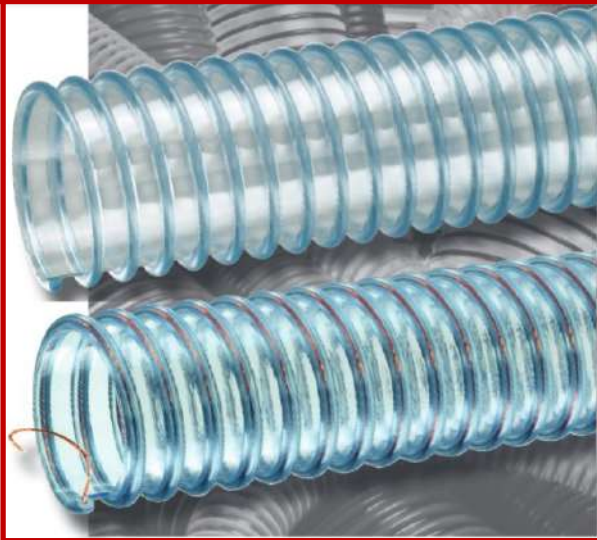

Mild Steel, Aluminum, Stainless Steel, Galvanized, all Tube & Pipe sizes.

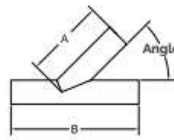

LATERAL

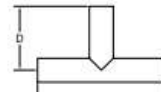

TEES



PARALLEL WYE

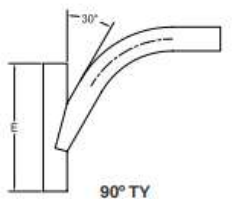

90° TY

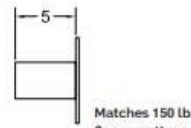

FLANGE TUBE ADAPTER (specify sizes)

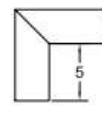

SQUARE 90° (specify OD)

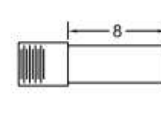

THREADED ADAPTER (male & female)

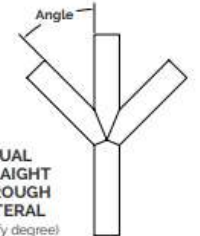

DUAL STRAIGHT THROUGH LATERAL (specify degree)

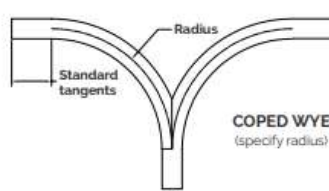

COPED WYE (specify radius)

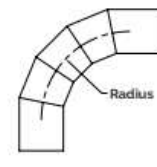

SEGMENTED ELBOW (specify radius & number of segments)

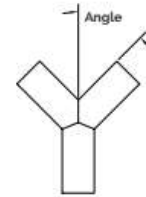

TRUE WYE (specify degree)

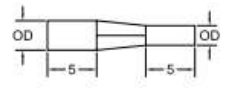

REDUCER (specify outside diameters)

TUBE VS TUYAU

2" TUBE

OD = 2"

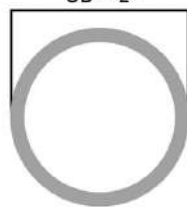

2" PIPE

OD = 2.375"



PLIAGE / BEND-

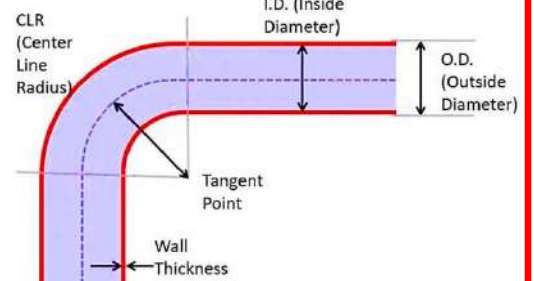

Air Filters



Compressor and Vacuum Pump Filters



Dust Collector Filter



Hydraulic/Oil Filters



Liquid Filter Cartridges



Custom Filter Designs

CAMLOCKS



Type A



Type B



Type C



Type D



Type E



Type F



Type DC



Type DP

Consultant Projets

BARWAY

Équipements et consultant pour l'industrie du plastique
Equipment and consulting for the plastic Industry



Marc Viau

President

marcviau@barway.ca

WWW.BARWAY.CA

Tel: 450-455-1396
Cell: 450-567-0380

BARWAY

Équipements et consultant pour l'industrie du plastique
Equipment and consulting for the plastic Industry



Peter K Booth

Ventes Interne / Inside Sales

peterbooth@barway.ca

WWW.BARWAY.CA

Tel: 450-455-1396
Cell: 514-918-8393

Soutien Tech

BARWAY

Équipements et consultant pour l'industrie du plastique
Equipment and consulting for the plastic Industry



Alex Viau

Vice-President

alexviau@barway.ca

WWW.BARWAY.CA

Tel: 450-455-1396
Cell: 450-802-8268





Équipements et consultant pour l'industrie du plastique
Equipment and consulting for the plastic Industry

BARWAY

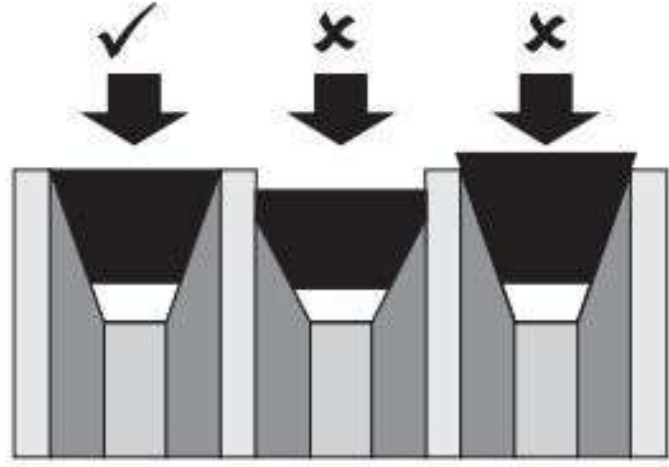

COURROIES / BELTS

LIGHT DUTY

Pour des moteur a HP fractionelle (Ex..1/2hp, 1/3hp)

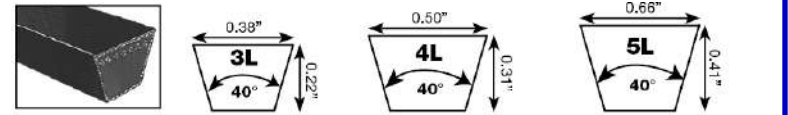

CLASSICAL HEAVY DUTY

USAGE INTENSIF

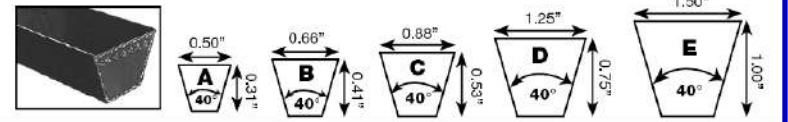

MOLDED COGGED

Permettent l'utilisation de poulies plus petites et assurent une meilleure dissipation de la chaleur

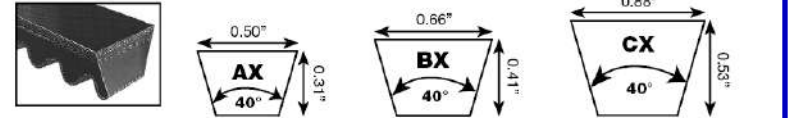

WEDGE

Profil plus étroit et plus profond, permettant des applications plus petites



WEDGE COGGED

Profil plus étroit et plus profond, permettant des applications plus petites, sur poulie étroite.

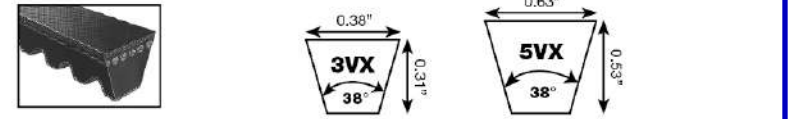

TYPES DE RACCORDS HYDRAULIQUE

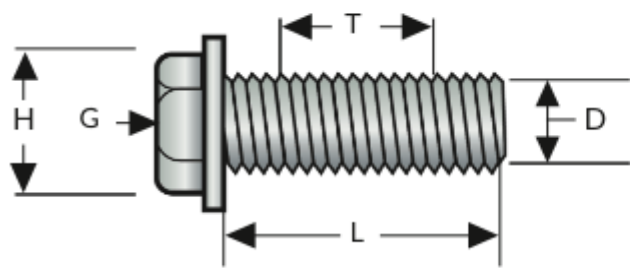
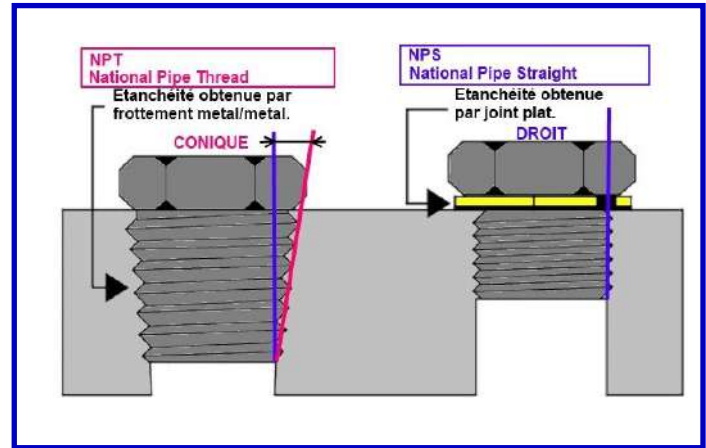
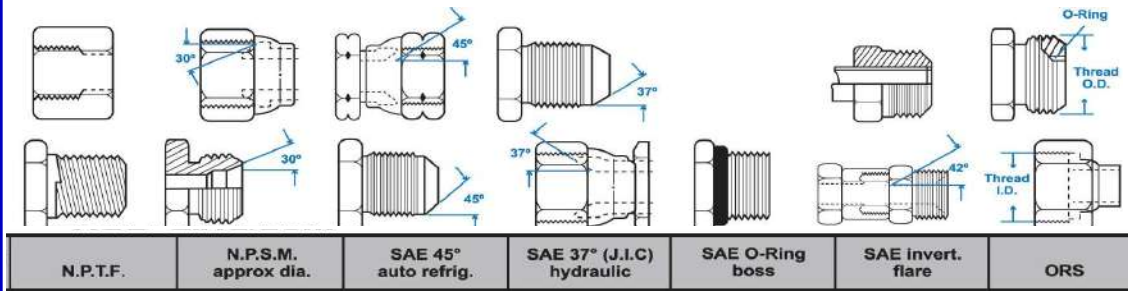

H = Head
G = Grade marking (Bolt strength)
L = Length (Inches)
T = Thread pitch (Thread/Inch)
D = Nominal diameter (Inches)



English Terminology

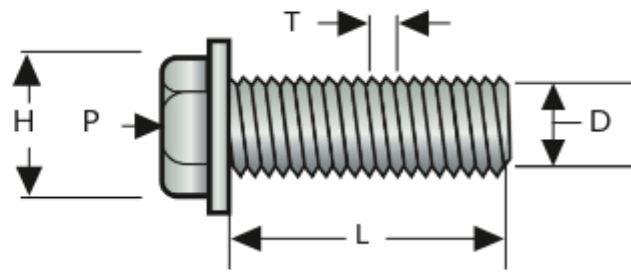

H = Head
P = Property class (Bolt strength)
L = Length (Millimeter)
T = Thread pitch (Thread/Millimeter)
D = Nominal diameter (Millimetre)



Metric Terminology

EUROPE ISO	USA SAE
No Marking	No Marking
Grade: 4, 8 (4.6, 5.8) Tensile: 429 MPa (60,900 psi)	Grade: 2 Tensile: 60,000 psi
8.8	Grade: 5 Tensile: 120,000 psi
10.9	Grade: 8 Tensile: 150,000 psi
12.9	Grade: ASTM A574 Tensile: 170,000 psi Note: Generally not marked

SOLENOIDE

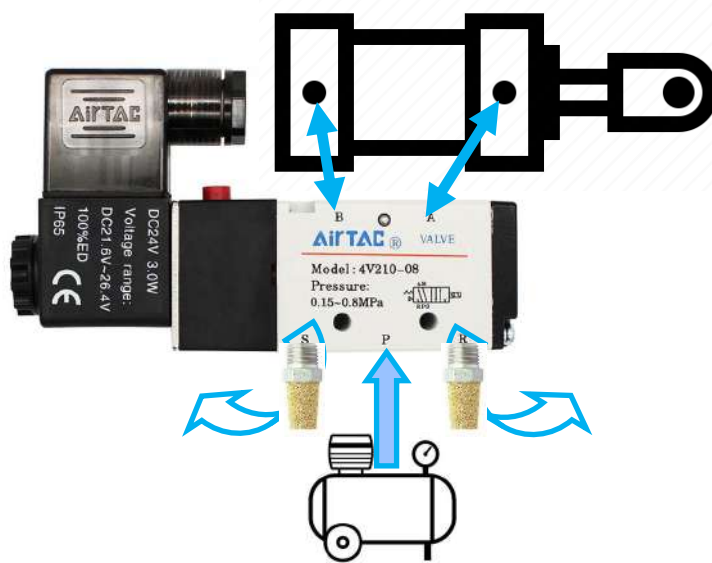
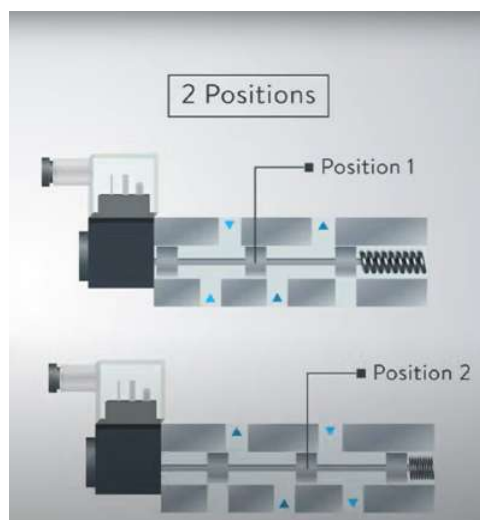
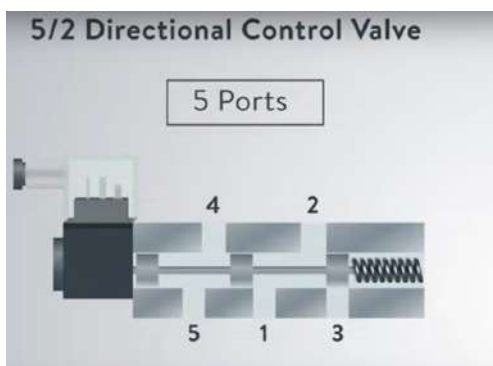

- **INFO TYPIQUE REQUIS POUR COMMANDER UN SOLENOIDE**
- **Ports** : nombre de ports et grosseur / number of ports and size
- **Positions**: 2 - 3
- **Operation**: Normalement Ouvert ou Fermé / Normally open or closed
- **Pipe Size**: Grosseur de la ligne ou debit requis / Pipe size or flow requirement
- **Media**: Aire, huile, autre / Air, oil, water, other
- **Press** Min-Max Pression / Min-Max Pressure
- **Temperature**: **Environment et materiaux** / **Environment and material**
- **Voltage**: 24VDC /120VAC ou manuel / or manual